

Trendy and original, K-Flex is a silicone-coated LED strip mounted on transparent acrylic.



OUR COMMITMENTS



17 colors available



21 day lead time from validation of technical drawings to delivery



Dismountable and repairable



Up to 5 years guarantee

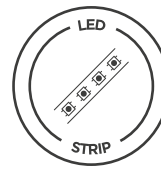

SPECIFICATIONS

PRODUCT SPECIFICATION

Materials: Acrylic / Silicone

Paint: RAL or Pantone

Mounting: Threaded rods / Spacer / Screws

Voltage: 12 V

Production: CE-certified components

Protection rating: IP 62

Working temperature: -10 to 50

Fire class certification: PMMA certificate (for bottom) (M4)

LED SPECIFICATION

Brightness: Up to 1800 cd/m²

LED source LUM flux: 55 Lumen

Efficiency of finished product: 90 Lumen/watt

Power consumption per LED (white): 0.1 Watt

Life span: 70% to 10,000 hours

LED color specified: No

Dimmable : Yes

Installation of replacement letters: Yes

TECHNICAL DRAWING

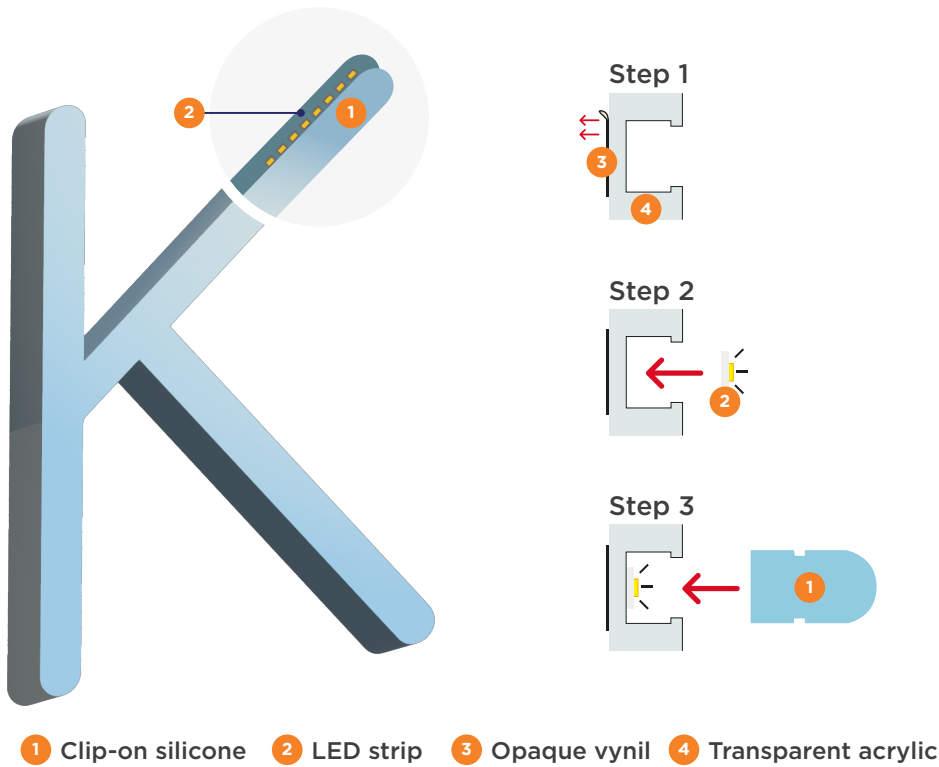

THE KALISIGN SPIRIT

Customized solutions with a wide choice of :

- + LED strip colors
- + Cut-outs for transparent acrylic
- + PT® and Respect® brand acrylics

AVAILABLE COLORS

- | | |
|--|---|
|  #1 - White silicon + white LED strip |  #10 - Green silicon + white LED strip |
|  #2 - Red silicon + white LED strip |  #11 - Green silicon + green LED strip |
|  #3 - Red silicon + red LED strip |  #12 - Yellow silicon + white LED strip |
|  #4 - Dark pink silicon + white LED strip |  #13 - Yellow silicon + yellow LED strip |
|  #5 - Dark pink silicon + dark pink LED strip |  #14 - Orange silicon + white LED strip |
|  #6 - Pink silicon + white LED strip |  #15 - Orange silicon + orange LED strip |
|  #7 - Pink silicon + pink LED strip |  #16 - Dark blue silicon + white LED strip |
|  #8 - Light blue silicon + white LED strip |  #17 - Dark blue silicon + dark blue LED strip |
|  #9 - Light blue silicon + light blue LED strip | |